

Alternate Brace Panel

TIE-DOWN FORCE (lb)	HEIGHT OF BRACED WALL PANEL				
	SHEATHED WIDTH				
	8 ft. 2'-4"	9 ft. 2'-8"	10 ft. 2'-8"	11 ft. 3'-2"	12 ft. 3'-6"
One-Story	1800	1800	1800	2000	2200
First Story of a Two Story	3000	3000	3000	3300	3600

ALTERNATE BRACE WALL PANEL PER 2018 IRC:

- 1) EACH PANEL SHALL BE A MIN. 2'-8" IN LENGTH W/A MAX. HEIGHT OF 10'-0"
- 2) EACH PANEL SHEATHED ON ONE FACE W/MIN. 3/8" PLYWOOD W/ALL EDGES BLOCKED
- 3) ATTACH PLYWOOD W/8d COMMON OR GALVANIZED NAILS
- 4) EACH PANEL SHALL BE ATTACHED TO THE FOUNDATION W/A MIN. OF 2 ANCHOR BOLTS INSTALLED AND PLACED AT PANEL QUARTER POINTS.
- 5) FOUNDATION CONTINUOUS ACROSS ENTIRE LENGTH OF BRACED WALL LINE AND REINFORCED W/ NOT LESS THAN (1) NO.4 BAR TOP AND BOTTOM

** IN THE FIRST STORY OF A TWO-STORY BUILDING, EACH PANEL SHALL BE CONSTRUCTED AS FOR A ON-STORY BUILDING WITH THE FOLLOWING EXCEPTS:

- 1) SHEATHING EDGE NAILING SPACING SHALL NOT EXCEED 4" o.c. IN THE FIRST STORY
- 2) THREE ANCHOR BOLTS PER PANEL PLACE AT ONE-FIFTH POINTS

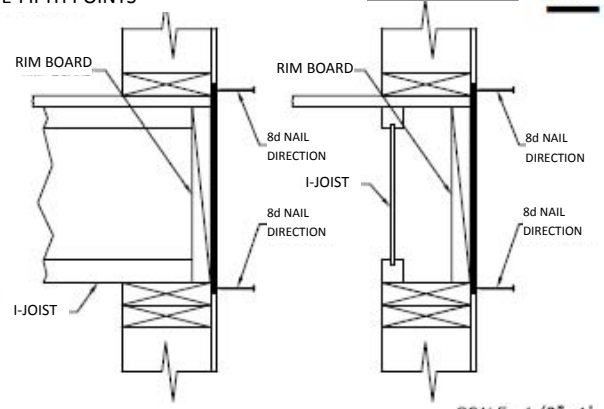
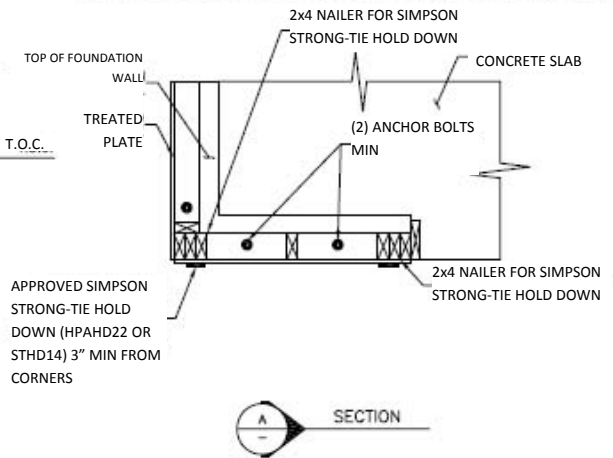
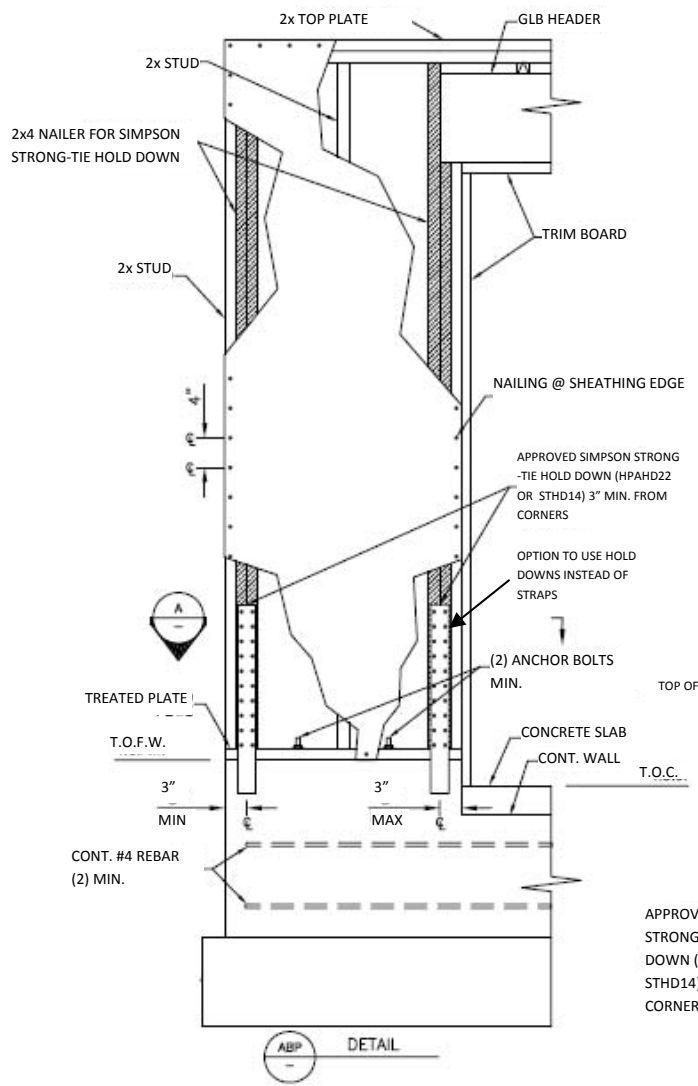

ADJOINING PANEL EDGES FROM FLOOR TO FLOOR
 SCALE: 1/2"=1'
 DRAWN BY: LPB
 DATE: 1-24-08
 SHEET 1 OF 1